

5 Series "Auto-Reversing" Mortise Lockset Installation Instructions®

Trim Installation: Knob or Lever Plates

1. Remove faceplate from lock.
2. Position exterior plate assembly, making sure the spring-loaded spindle engages with lock.
3. Place rings/spacers over cylinder and screw into lock body, making sure the key slot is aligned vertically toward the lever.
4. Tighten cylinder set screw using a **No. 1 screwdriver bit ONLY.**
5. Replace faceplate on top of backplate and secure with two screws.
6. Position interior plate assembly with turnpiece and spring-loaded spindle, making sure the spindle engages with lock.
7. Insert and tighten mounting screws securely.
8. Check lock for proper operation before closing door.

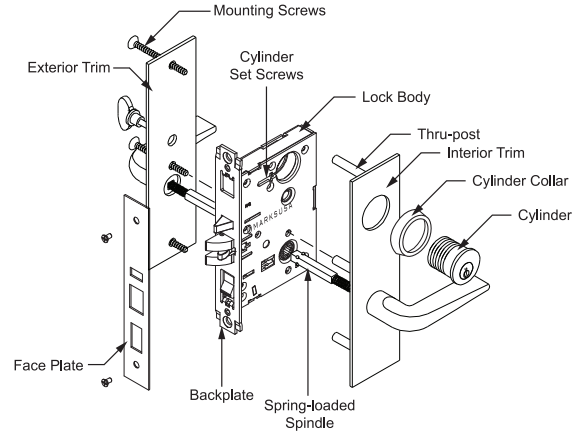

Trim Installation: Lever Rose

1. Remove faceplate from lock.
2. Position exterior and interior rose assemblies, making sure the spring-loaded spindle engages with lock from both sides.
3. Insert and tighten mounting screws securely from inside.
4. Slide rose cover lever, making sure to align notches on cover with slots in rose (horizontally) and snap on.
5. Position turnpiece assembly and secure with screws.
6. Place rings/spacers over cylinder and screw into lock body, making sure the key slot is aligned vertically toward the lever.
7. Replace faceplate on top of backplate and secure with two screws.
8. Check lock for proper operation before closing door.

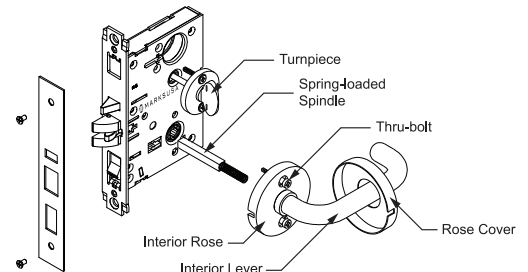

Trim Installation: Knob Rose

1. Remove faceplate from lock.
2. Position exterior thru-bolted assembly and spring-loaded spindle, making sure the spindle engages with lock.
3. Place and secure inside rose with mounting screws.
4. Position rose shell and align notches on cover with slots in rose (horizontally) and snap on.
5. Insert knob with spring-loaded spindle through inside rose, making sure the spindle is engaged with lock.
6. Screw the threaded bushing into rose and tighten securely with spanner wrench (supplied).
7. Position turnpiece assembly and secure with screws.
8. Place rings/spacers over cylinder and screw into lock body, making sure the key slot is aligned vertically toward the lever.
9. Replace faceplate on top of backplate and secure with two screws.
10. Check lock for proper operation before closing door.

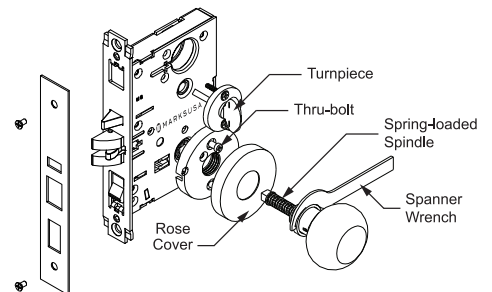

5 Series "Auto-Reversing" Mortise Lockset Installation Instructions®

REVERSE LATCH

1. Remove front plate.
2. Depress latch, unscrew both latch screws (one from each side of the lock).
3. Tilt latch cam to remove latch. Re-insert for desired handing.
4. Replace the latch screws and adjust bevel of backplate.
5. Replace front plate.

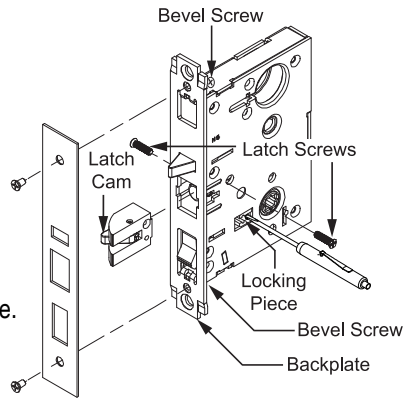

HANDING THE HUBS

1. Push locking piece toward desired locked side.
2. Check for proper operation before installation.

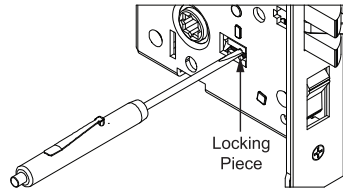

HANDING EXAMPLES

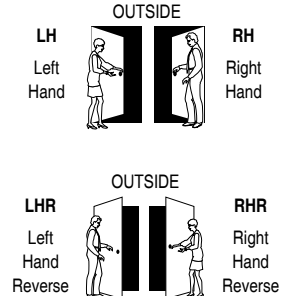

TO BEVEL LOCK

1. Loosen adjustment screws at top and bottom of case.
2. Turn front to desired bevel.
3. Re-tighten adjustment screws.

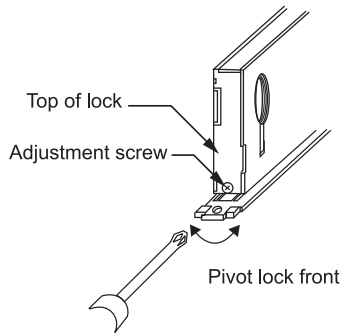

LUBRICATION

All locks come lubricated from the factory with a lithium based grease. We recommend, however, continued periodic lubrication of internal moving parts with a commercial quality grease. This can add years to the life of the lockset by reducing excessive wear. For more severe environments, lubrication should be applied more frequently.

1. Push locking piece toward desired locked side.
2. Check for proper operation before installation.

Trim Installation: Handle, Knob or Lever Mortise Locksets

PREPARING THE DOOR:

Note: If the strike already exists in the door frame, position lock using strike as reference.
(See strike position on template)

1. Draw horizontal line on both sides and edge of door at the desired height of knob above floor.
2. Draw vertical center line on door edge.
3. Draw vertical line on each side at the proper backset to align the templates.
4. Position templates on edge and sides of door. Mark holes **ONLY** for each side, and top and bottom holes of mortise cavity on door edge.
5. If lock has anti-friction latch, mark proper recess area on door edge template.
(See lock body to determine proper side.)
6. Remove template; place lock face against door edge. Trace outline of faceplate as guide for faceplate routing.

MORTISE THE DOOR:

1. Mortise door for lock body and faceplate per instructions on template.

INSTALLING THE LOCK BODY:

1. Insert the lock into the cavity.
2. Mark & drill faceplate holes. Fasten with faceplate screws to hold lock in place.
3. Unscrew cylinder set screw enough to allow the cylinder to thread into the lock.

INSTALLING THE STRIKE:

1. Refer to template to determine strike location on jamb.
2. Using strike as template, mark and chisel recess. Drill screw holes and fasten.

